



## Global Connection International

*Connecting People who care with the World's Greatest Needs*

*Dear Friends,*



*This is the city of Moshi, Tanzania. Moshi is situated on the lower slopes of Mt. Kilimanjaro, a volcanic mountain that is the highest mountain in Africa.*

*Jim first visited Tanzania in 1997 and Cam visited in 1999.*



*It was on these trips that we met Rev. Unity Msami who we have worked with all of these years. During this time we have sent over 10 short term mission teams. We have also had long term bi-vocational associates who have worked as educators for 3-12 months at a time. Steve Hart, a businessman from Billings, Montana returned last month from a one year teaching mission.*

***Rev. Unity Msami is our Tanzania Country Coordinator.***

***One of our Board Members, David Schlachter who serves as Vice-President of Peacemakers Ministries, is our bi-vocational associate for Tanzania. David and his family have made numerous trips to Tanzania.***

- Tanzania has been hard hit by **the HIV/AIDS epidemic**, with over 2 million adults and 150,000 children infected.
- Access to education is a big problem facing the country. **Over 40% of children do not have access to education.**
- **Health care needs for the poor are enormous!**
- Tanzania is one of the **poorest countries in the world**. Its people are friendly, welcoming, unassumingly proud and yet reserved. You'll be treated with uncommon warmth and courtesy wherever you go, and genuine friendships are easily made.

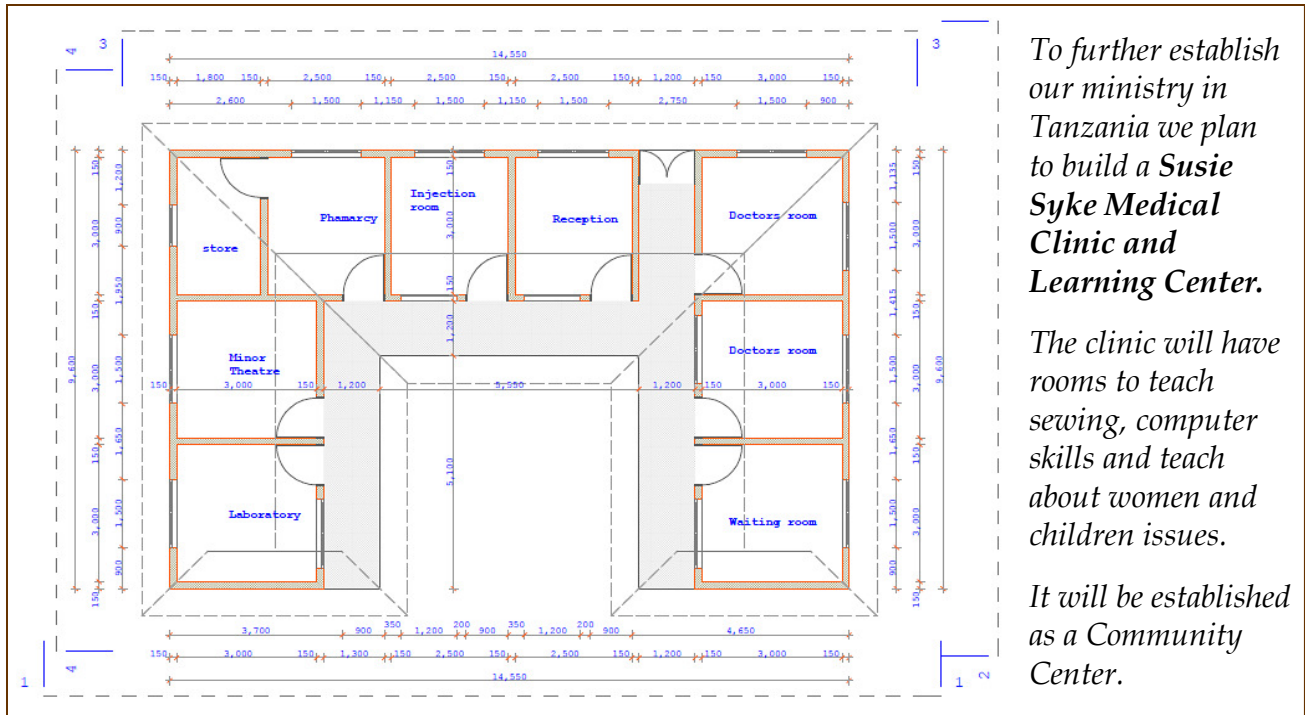

To further establish our ministry in Tanzania we plan to build a **Susie Syke Medical Clinic and Learning Center**.

The clinic will have rooms to teach sewing, computer skills and teach about women and children issues.

It will be established as a Community Center.

**The cost of the project will be \$50,000.00 and the construction team is ready to begin.** To start the project a \$15,000.00 matching grant has been raised. When matched, these funds will help us with the first phase of the project.

In the area of the clinic --- **which is predominately Muslim**, there are about 20 good churches. The Clinic and Community Center will enhance the compassion of the Christian faith and provide for the community regardless of the faith of the person.

As you consider this important need -- keep in mind that for each \$1.00 you contribute it will double. **Your gift of \$100.00 will double to \$200.00.**

The Susie Syke Clinic which we have built in Nicaragua has become a very powerful outreach in the community -- so your gift can help make this possible in Tanzania.

We will be thankful for whatever the Lord leads you to contribute.

Yours for the cause that counts,

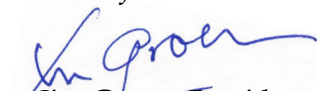
  
Jim Groen, President

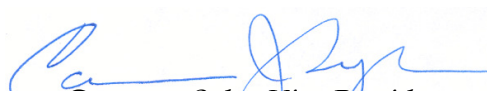
  
Cameron Syke, Vice President